

# AVANI RIVERSIDE BANGKOK HOTEL

Essential comforts, great views and easy trips.

With a seamless blend of contemporary style and modern warmth, the AVANI Riverside Bangkok Hotel is perfect for any kind of visit. From honeymoons to getaway holidays to business trips, the custom AVANI blend of relaxed comfort and inspiring spaces makes this a great spot to unwind and recharge.

Overlooking Bangkok's bustling Chao Phraya River, AVANI Riverside Bangkok Hotel is perfectly situated to get away from the hustle and bustle of the city, to grab a bite, see the sights or head to a meeting. Shuttle boat services to the BTS skytrain at the Saphan Taksin boat pier and Bangkok's largest night market and entertainment area at Asiatique make connecting to the city's major commercial, shopping and entertainment districts a breeze, but if you prefer to stick close, Riverside Plaza has a myriad of shops and entertainment outlets to keep you occupied.

<b>Opening Date:</b>	May 2016
<b>Address:</b>	257 Charoennakorn Road, Thonburi, Bangkok 10600, Thailand
<b>Telephone:</b>	+66 (0) 2431 9100
<b>Facsimile:</b>	+66 (0) 2431 9111
<b>Central Reservations:</b>	+66 (0) 2365 9110
<b>Central Reservations Email:</b>	<a href="mailto:reserveavani@avanihotels.com">reserveavani@avanihotels.com</a>
<b>Email:</b>	<a href="mailto:riverside.bangkok@avanihotels.com">riverside.bangkok@avanihotels.com</a>
<b>Web Address:</b>	<a href="http://avanihotels.com/riverside-bangkok">avanihotels.com/riverside-bangkok</a>

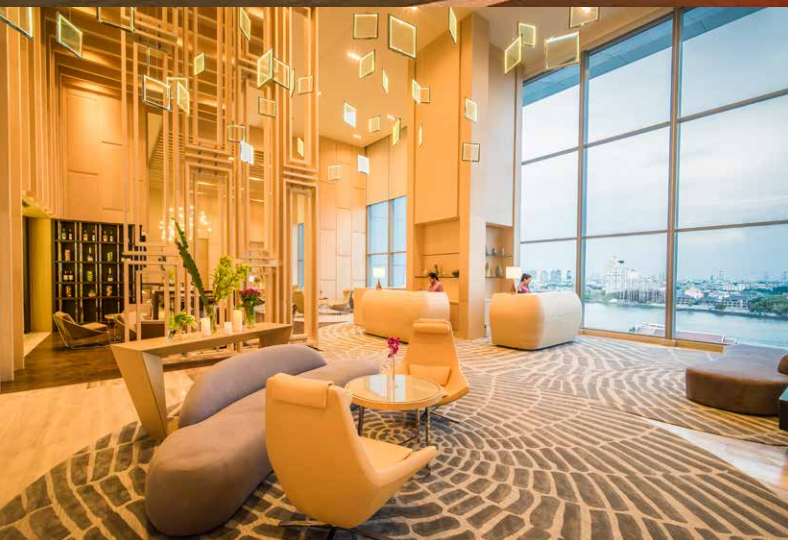

<b>Management:</b>	AVANI Hotels & Resorts
<b>Ownership:</b>	Minor International PCL
<b>Cluster General Manager:</b>	Nikolaus Priesnitz
<b>General Manager:</b>	Christian Hoechtl
<b>Director of Sales &amp; Marketing:</b>	Paul Counihan



## ESSENTIAL ROOM COMFORTS

AVANI Riverside Bangkok Hotel offers 248 guest rooms including 23 suites, all on levels 12 and above; with fantastic river views. Each guest room is refreshingly understated showcasing the contemporary sense of style, combined with warm and hospitable spirit. Practical yet sophisticated in character, personal touches and little details ensure a memorable experience.

### AVANI River View Room (30 SQM)

AVANI RiverView Rooms offer the perfect space to relax, work and sleep in style. Stay connected with WiFi access. Make yourself comfortable with a fully stocked mini bar and take in an uninterrupted view of the River of Kings. Enjoy essential comforts at your finger tips with our IPTV system. Sink into sleep with ease and wake up feeling fresh and ready for the day ahead.



### AVANI River View Junior Suite (62 SQM)

AVANI RiverView Junior Suites spoil you with generous space and contemporary comforts. The fresh crisp white bathroom flows into a delightful well-appointed bedroom. Keep in touch with WiFi and allow our IPTV system to take care of your every need. Soak in panoramic river views through wide windows from your bedroom or as you soak the day away in a full size tub.



## AVANI River View Two Bedroom Suite (138 SQM)

Families and friends have plenty of space to stay and play in our two-bedroom, two-bath suites. Separate living and dining spaces, plus a kitchen and wet bar, mean that everyone can stretch out in style and enjoy WiFi, mini bar snacks, added comforts from the IPTV system and the endless views of the river.

## AVANI River View Three Bedroom Suite (166 SQM)

With modern style and exceptional amenities amongst suites in Bangkok, the AVANI River View three-bedroom, three-bath suite was designed with you in mind. Stay plugged in with WiFi and enjoy the benefits of the IPTV system. Sink into the bathtub to relax and unwind. Sneak into the full kitchen and wet bar for a midnight snack, or just nibble from the mini bar. Enjoy exceptional views of the River of Kings, along with all the details that matter to those travelers seeking a luxurious getaway on the river.



Room Type	Total		Room Size (sqm)	Accept Roll Away	Maximum Capacity
AVANI River View Room	225 Rooms		30	No	2 Adults
	118 King	107 Twin			
AVANI River View Junior Suite	20 Rooms		62	Yes	3 Adults
	19 King	1 Twin			2 Adults + 1 Child
AVANI River View Two Bedroom Suite	2 Suite		138	Yes	5 Adults
	2 King / 1 King + 1 Twin				3 Adults + 2 Children
AVANI River View Three Bedroom Suite	1 Suite		166	Yes	7 Adults
	2 King + 1 Twin				6 Adults + 1 Child
Total	248 Rooms				





## ROOM FEATURES

- All rooms and suites enjoy panoramic river views
- Rooms and suites from level 12 and above
- King or twin beds
- Spacious lounge areas for suites
- In-room mini bar
- Tea and coffee making facilities
- Select suites come with full kitchen and wet bar
- LCD TV
- Complimentary internet access via LAN and WiFi
- IPTV - Internet Protocol Television, an interactive live TV-based service

## REFRESH & RELAX

Take in stunning uninterrupted views of the river and city skyline from the roof-top 25-metre infinity swimming pool. Enjoy an energetic session at the fully equipped gym AVANIFIT or treat yourself to a well-deserved pampering at the AVANISPA or join in on one of our 'local experiences' for a true taste of local life.

- AVANISPA
- AVANIFIT
- Rooftop Infinity swimming pool from 6:00 am – 7:00 pm
- Pool Bar
- Nightly live music
- Local experiences
- Shopping and entertainment

## GUEST SERVICES

- Business Centre
- Concierge / AVANI Welcome at level 1
- Babysitting
- Meeting and banquet facilities
- Wedding facilities
- Complimentary shuttle boat service to SaphanTaksin skytrain station (15 minutes)
- Complimentary shuttle boat service to Asiatique night market and entertainment area (5 minutes)
- Tuk-tuk service to Krung Thonburi skytrain station (15 minutes)
- Riverside Plaza for shopping and entertainment (within the hotel building)
- Anantara Riverside Bangkok Resort for dining and entertainment (within walking distance)





## WINE & DINE

From specialty dining with focus on 'Honest Food' concepts to designer deli goodies, four in-house restaurants and bars offer a fuss free take on delicious simplicity and views worth lingering over. Savour sunrise or sunset by the river-side, or drink and dine while taking in the view from the rooftop. On the go? Grab a quick snack from the PANTRY AT AVANI or meet up over refreshments at the lobby bar.



## ATTITUDE

**Bar & Restaurant open** 6:00 pm – 1:00 am  
**Infinity Bar open** 10:00 am – 6:00 pm

Hipe the Social Drinking scene with sundowner drinks or artisan cocktails and enjoy Social Dining with signature tapas creations at Bangkok's largest and stylish rooftop bar by the infinity pool. Marvel at the capital's spectacular skyline or for more action, watch our chefs innovate specialties in the open kitchen or our mixologist churn out crafted concoctions as you socialize the night away.

## PANTRY AT AVANI

**Open 24 hours**

Whether it's 2:00 am or 2:00 pm, this designer deli has specialty snacks at the ready. Grab a quick bite on the way out the door, or pick up treats for two for a casual meeting in the lobby





## Skyline

Open 6:00 am – 10:00 pm

Savour sunrise and sunset with uninterrupted views of the Chao Phraya River at Skyline, our all day dining restaurant. Serves an international breakfast and dinner buffet filled with local specialties. Craving something specific? A la carte treats are also available.

## Longbar

Open 11:00 am – 10:00 pm

A selection of snacks and delightful afternoon tea is served at the modern and welcoming lobby bar, offering the perfect spot to connect with friends or unwind after a long day



## Numero Uno Café

Open 7:00 am – 10:00 pm

Perfect for freshly baked pastries, chocolates or a sandwich for a light snack. Handcrafted delicacies make for the ideal gift.



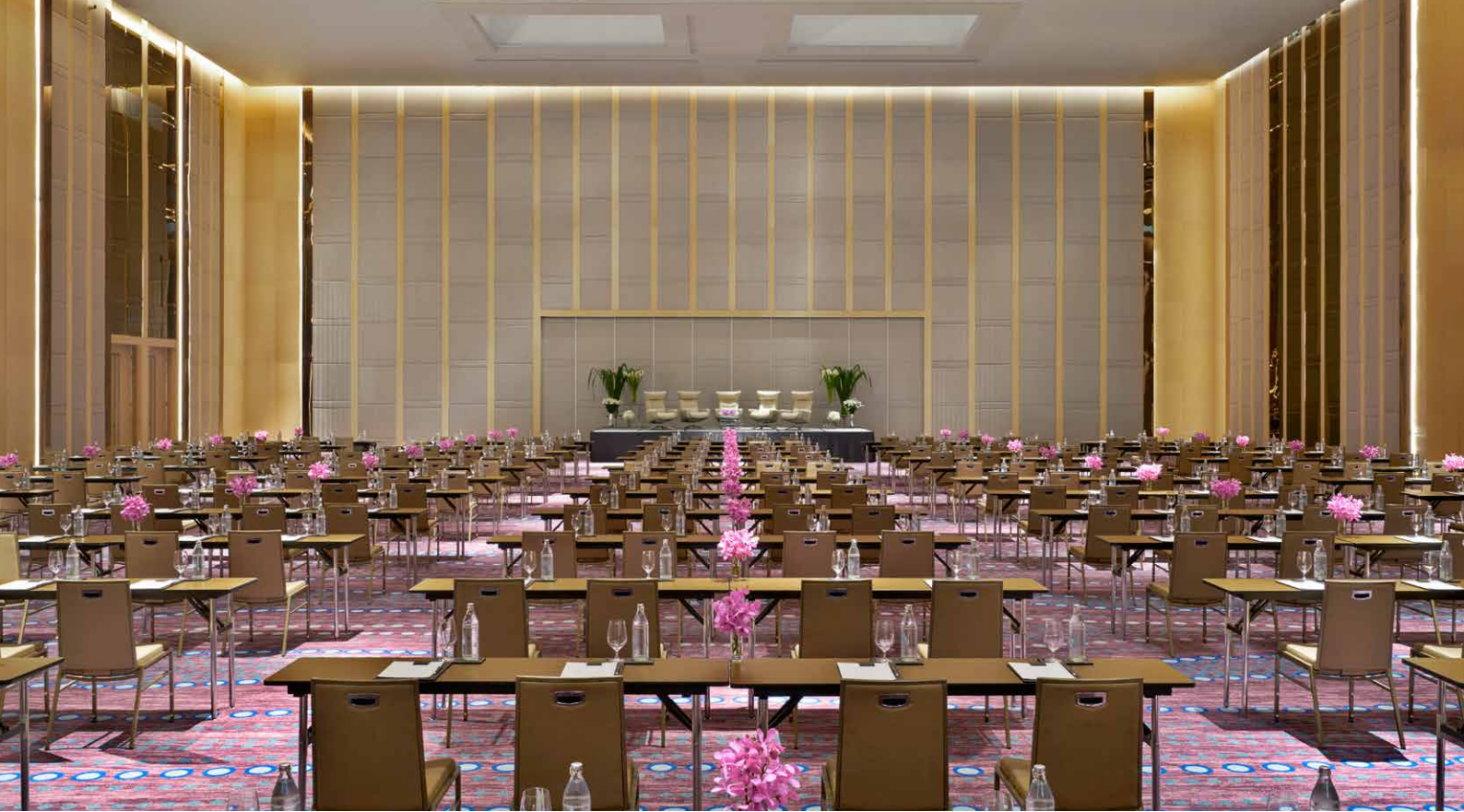

## MEETINGS, EVENTS & WEDDINGS

AVANI Riverside Bangkok Hotel offers the right space for every event making it one of the most iconic and most versatile locations in Bangkok and Asia. The impressive meeting and event facilities boast 4,500 sqm of inspiring multipurpose space.

The 10th floor meeting facilities offer the most memorable views over the City of Angels, impress and delight your guests by holding your celebrations at Grand Riverside Ballroom or at our roof top bar located on the 26th floor: AVANI Riverside Bangkok Hotel events and conference facilities offer the most flexible and state of the art MICE (Meetings, Incentives, Conferences and Exhibitions) facility in Bangkok.

### THIS ICONIC VENUE HAS A CAPACITY FOR:

- 1,500 delegates
- 80 exhibition booths
- Accommodates 27 meeting rooms at AVANI Riverside Bangkok Hotel and Anantara Riverside Bangkok Resort
- Bangkok's highest sophisticated Grand Ballroom (with a 11 metre high ceiling and the capacity to accommodate 900 guests banquet-style, 1,200 guests for a staged performance or 1,500 guests for theatre-style)
- Car Lift with direct access to the Grand Ballroom with an impressive weight load of 3,000 kg [the size of the Car Lift is at 6 m (L) x 2.6 m (W) x 2.2 m (H)]
- The meeting spaces boast a notable 1 ton live load per square metre
- The Terrace, an outdoor balcony for evening cocktails with dramatic views of Bangkok's skyline by night
- Generous pre-function areas for added space for large conferences

But it's more than just the numbers. You can count on the personal attention you deserve for the smallest of gatherings to the biggest conventions.











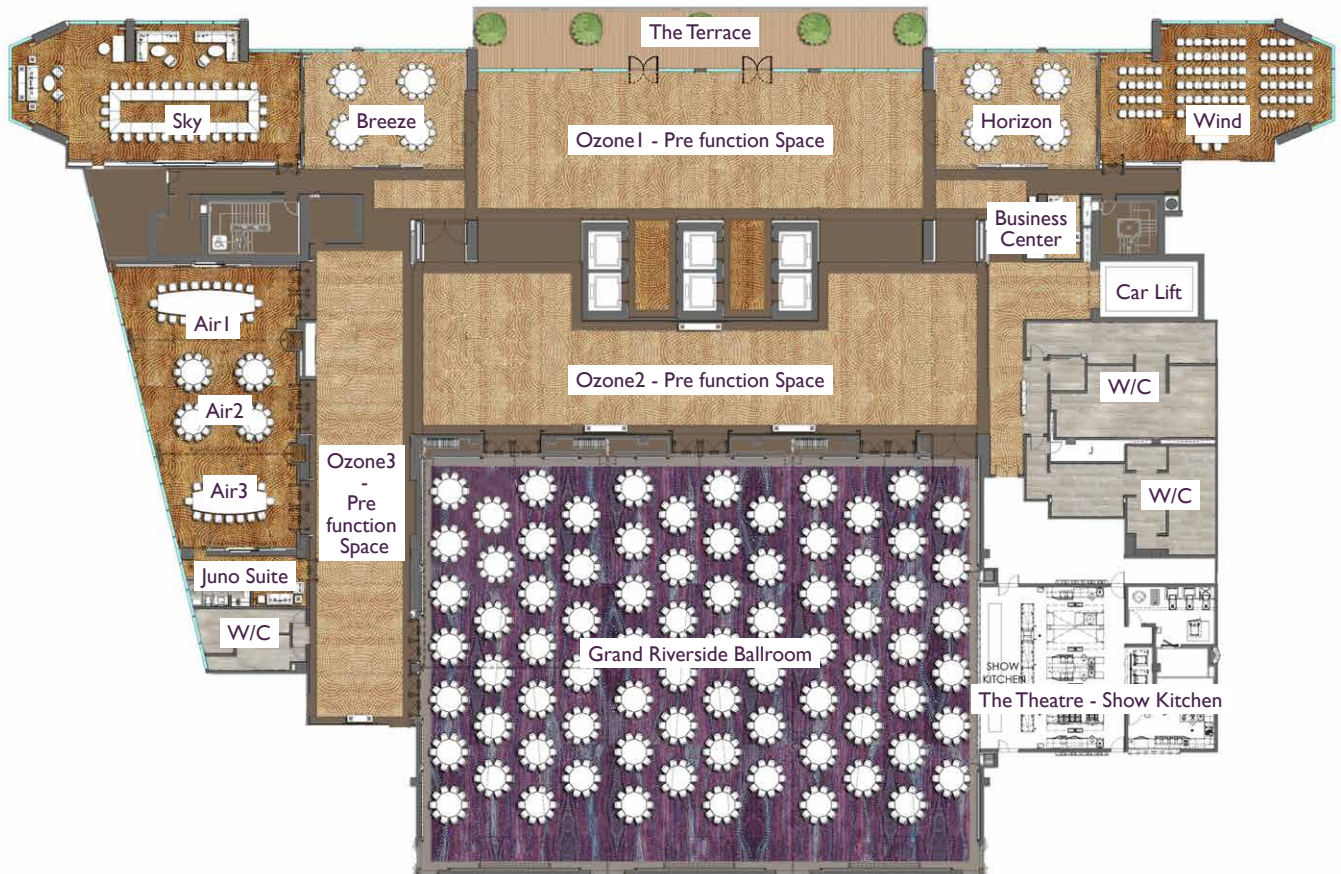

## GRAND RIVERSIDE BALLROOM

Featuring one of the largest Grand Ballrooms on the river that has been especially designed to cater to groups of all sizes. Located on level 10, the ballroom can be separated into up to 4 different spaces and also includes the unique option of opening up onto a first of its kind, 'show kitchen'. Natural lights and warm hues of the high walls add to the ballroom's contemporary design and stylish character.

Fully equipped with the latest in audio-visual technology, our ballroom and function rooms offer easy flexibility whether it is a boardroom for 18 or a banquet for 780 guests.

# CONFERENCE FACILITIES



Names	Area		Dimensions (W x L x H)		Seating Options						
					Theatre	Classroom	U-Shape	Boardroom	Banquet	Cocktail	H-square
	M.	F <sup>2</sup>	M.	Ft.							
Grand Riverside Ballroom	1152	12400	40 x 29 x 11	131 x 95 x 36	1377	520	360		900	1500	300
- Lunar	385	4144	13.3 x 29 x 11	44 x 95 x 36	460	170	120		240	425	100
- Moon	385	4144	13.3 x 29 x 11	44 x 95 x 36	460	170	120		240	425	100
- Galaxy	385	4144	13.3 x 29 x 11	44 x 95 x 36	460	170	120		240	425	100
• Galaxy 1	190	2050	13.3 x 14 x 11	44 x 47 x 36	220	80	50		120	200	50
• Galaxy 2	190	2050	13.3 x 14 x 11	44 x 47 x 36	220	80	50		120	200	50
Wind	140	1507	8 x 18 x 7	26 x 58 x 23	136	50	35	40	80	125	30
Sky	175	1883	8 x 22 x 7	26 x 72 x 23	170	65	45	30	120	155	35
Air	220	2368	11 x 23 x 7	32 x 75 x 23	265	90	70	35	180	240	60
- Air 1	65	699	7 x 9 x 7	23 x 30 x 23	92	35	24	60	30	85	20
- Air 2	80	861	10 x 10 x 7	26 x 33 x 23	94	35	20	20	40	85	20
- Air 3	60	645	6 x 11 x 7	18 x 37 x 23	76	30	20	20	30	70	18
Horizon	90	990	8 x 12 x 7	26 x 38 x 23	40	20	15	20	20	40	18
Breeze	90	990	8 x 12 x 7	26 x 38 x 23	40	20	15	20	20	40	18

Pre Function Areas	Area		Seating Options (Cocktail) 
	M.	F <sup>2</sup>	
Ozone 1	434	4672	800
Ozone 2	391	4209	400
Ozone 3	200	2152	400
The Terrace	120	1290	-

Additional Services	Area	
	M.	F <sup>2</sup>
The Theatre	150	1586
Business Centre	50	538
Juno Suite	40	430

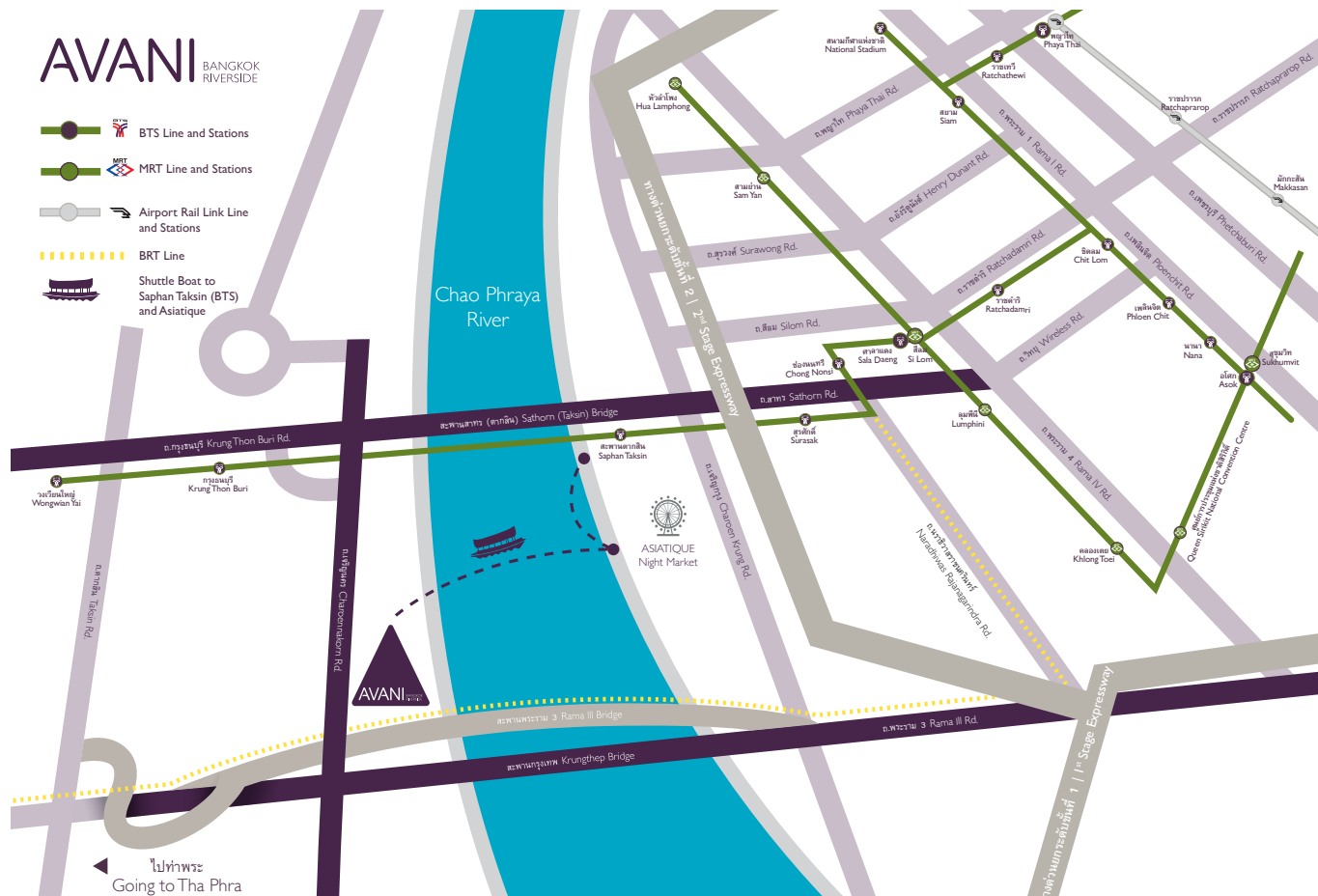

## LOCATION

AVANI Riverside Bangkok Hotel is approximately 1 hour from Suvarnabhumi International Airport and approximately 45 minutes from Don Muang Airport. Our hotel limousine services from both airports are easily arranged through the hotel. Public taxis are also available from the pick-up counters at the airport. Public transportation from the airport is available by connecting to the BTS skytrain from the Airport Rail Link.

AVANI Riverside offers complimentary return boat transfers to Saphan Taksin and the hotel, conveniently connecting to the city and 5 minutes to Asiatique. The hotel's tuk-tuk service is a novel way to experience this fascinating city and is available upon request for transfers from the hotel to BTS Skytrain at Krung Thonburi.

Whether you fancy a relaxing holiday by the pool or a thrilling urban adventure, our Bangkok riverside hotel is conveniently situated for either type of traveller.

## WEATHER

Bangkok has a tropical climate, similar to other parts of the country. From November to February, temperatures range from 18 to 32 degrees Celsius in Bangkok. The summer period is from March to June with the average temperatures in Bangkok within the range of 34-40 degrees Celsius; whereas the hottest period is in April. From July to October, Bangkok experiences the annual rainfall.

The best time to travel to Bangkok is between October to February when the temperatures and humidity are not as high, which makes it favourable for touring around this City of Angles. Night-time temperatures in December and January can be in the low 20s and this is the best time to experience the beauty of the River of Kings as the skies are clear.

### GDS codes

Chain Code: GA

Galileo: B9038

Amadeus: BKKRIV

Sabre: 305459

Worldspan: BKKRI

Pegasus: ADVRIV